

# ART AT THE ADAMANY

---

A GUIDE TO WORKS FROM THE UNIVERSITY ART COLLECTION  
AT THE DAVID ADAMANY UNDERGRADUATE LIBRARY

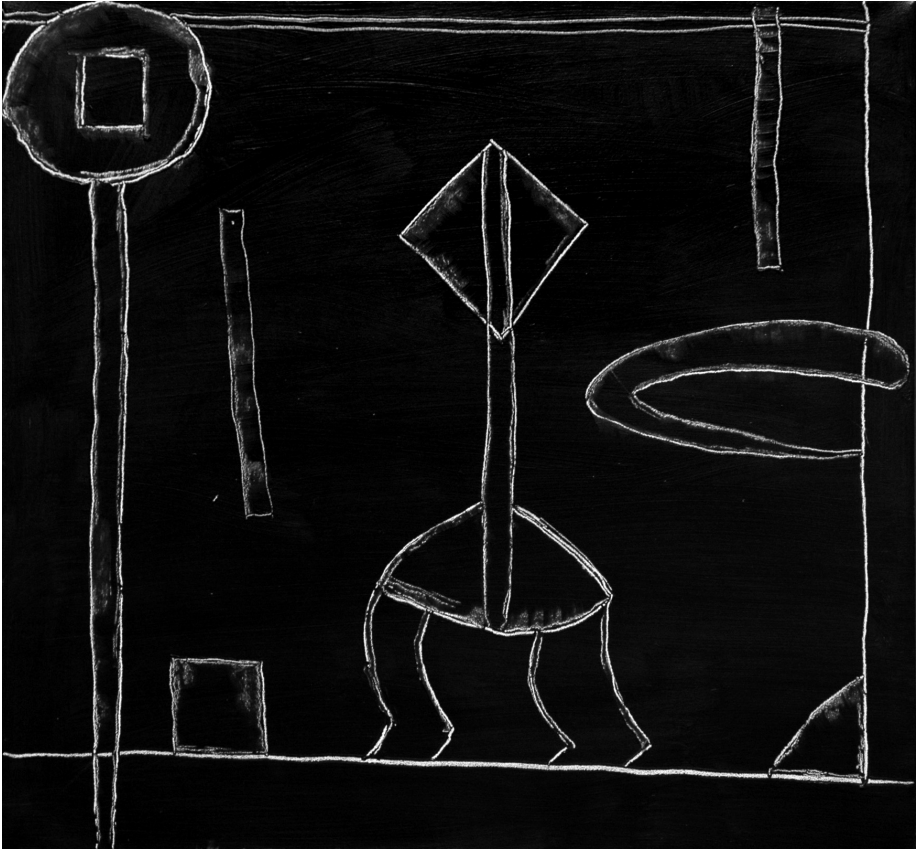



Jonathan Waite, *Anxious Moment*

The David Adamany Undergraduate Library, as part of the WSU Library System, is committed to providing quality resources, facilities and learning opportunities to students, educators and the community at large.

David W. Adamany, WSU president from 1982-1997, oversaw one of the largest building programs in the university's history and was instrumental in WSU being designated as a 'Research 1' university by the Carnegie Foundation for the Advancement of Teaching. Adamany was also an avid champion of the arts and it is fitting that this building, named in his honor, holds such a wealth of works from the WSU Art Collection. The building's expansive light-filled spaces and generous walls make it a natural for the display of some of the university's most important works.

As you enjoy the art, please be courteous to those around you. When viewing art at the Student Academic Success Services, the Irvin D. Reid Honors College, Community Engagement@Wayne offices and the University Library Dean's offices, please check in with personnel at the front desk and ask for permission to view the art.

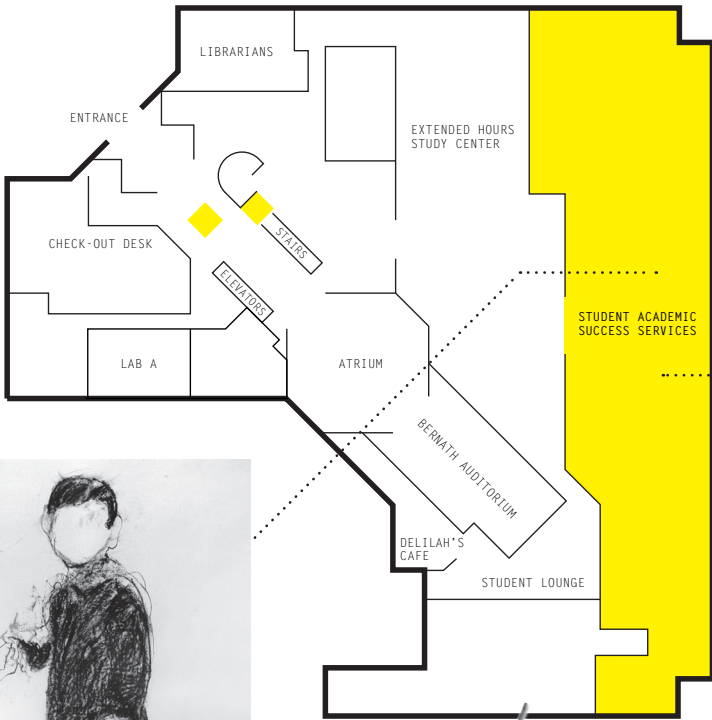

Ken Bowman, *Willie Sidney with No Face*

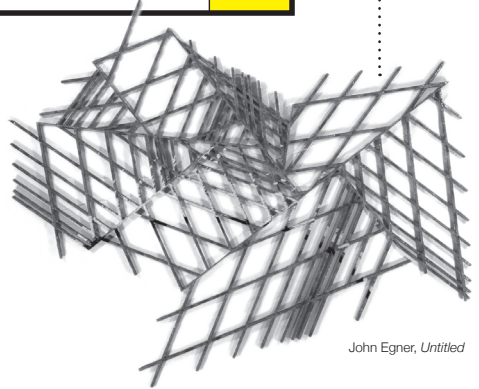

John Egner, *Untitled*

## FIRST FLOOR

### **Entrance**

*Al Loving – Life, Growth, Continuity*

This Pewabic tile mosaic, created by Detroit native Al Loving, was dedicated in 1998, one year after the library opened. The energy and message of this mural greet all who enter and sets the tone in creating an environment of art, education and discovery.

### **Student Academic Success Services**

Selections from the WSU Art Collection, featuring many works from Detroit's 'Cass Corridor' artists. (Visit the third floor exhibit *Cass Corridor Culture: In and Around Wayne State, 1960's – 1980's* to learn more about this important Detroit art movement.)

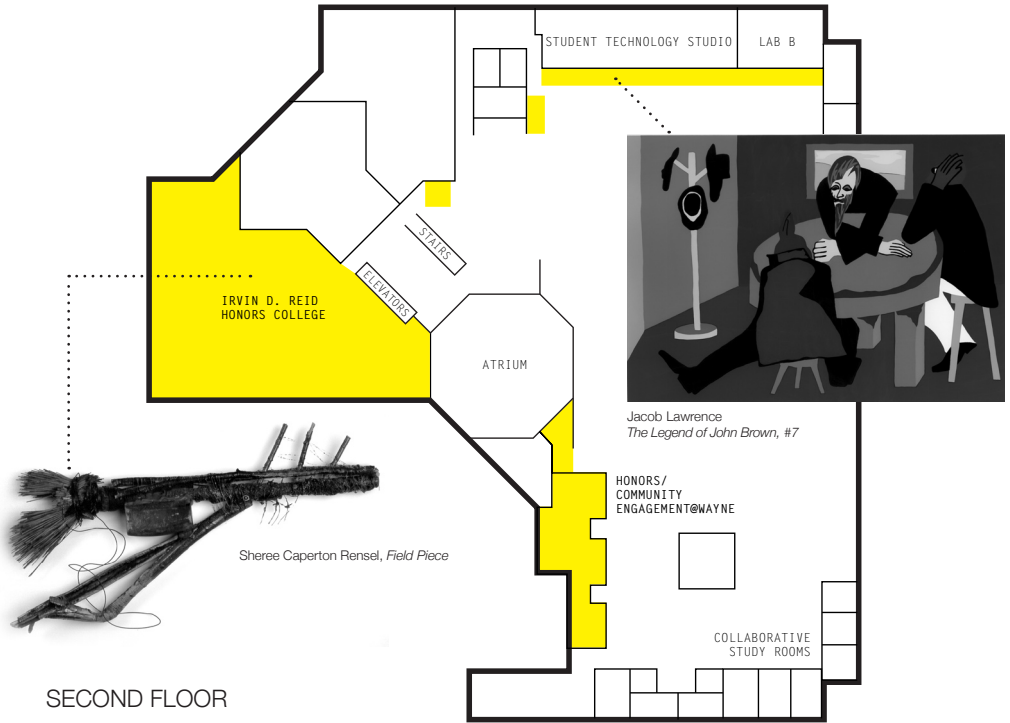

## SECOND FLOOR

### **Study Area**

#### *Jacob Lawrence – The Legend of John Brown*

In 1941, 24-year-old painter Jacob Lawrence began a series of gouache paintings on the abolitionist, John Brown. More than 35 years later, the artist revisited the series to produce 22 screenprints, based on the originals, now in the permanent collection of the Detroit Institute of Arts. This portfolio was acquired for the WSU Art Collection by the Office of President Adamany in 1994.

The narrative tells the story of John Brown who, with the support of northern abolitionists, organized a series of successful covert missions to liberate slaves from southern plantations. In the mid-1850s, Brown led antislavery troops in an effort to make Kansas a free state. His most famous act was the ill-fated attack on the Armory at Harper's Ferry, Virginia. Brown was later convicted of treason and hanged in 1859.

Lawrence remarked that, "The inspiration to paint the...John Brown series was motivated by historical events as told to us by the adults of our community...the black community. The men and women of these stories were strong, daring, and heroic; and therefore we could and did relate to these by means of poetry, song, and paint."

### **Irvin D. Reid Honors College/Community Engagement@Wayne**

Selections from the WSU Art Collection highlighting works by Michael Luchs, Nancy Mitchnick, Robert Sestok and other artists associated with Detroit's Cass Corridor.

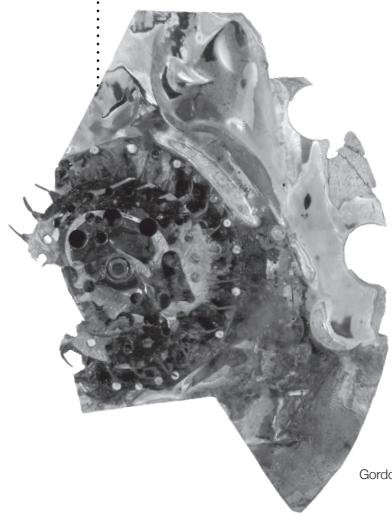

Gordon Newton, *Wheel of Fortune*



Ellen Phelan, *Untitled (Chair)*

THIRD FLOOR

**Office of the Dean, University Libraries**

Featuring works from the Edward W. Duffy & Company pipe warehouse gifted by James Pearson Duffy to the WSU Art Collection in 1992.

**Cass Corridor Culture: In and Around Wayne State, 1960's – 1980's**

This permanent exhibition highlights the work of artists, poets and musicians, many of whom lived and worked in 'the Corridor' during those years. The counterculture of the 1960s and '70s had its roots on college and university campuses, including WSU where artists, musicians, poets and writers developed a strong and vibrant creative community. This display features some of the most iconic art created by artists of the Cass Corridor, including works by Jim Chatelain, John Egner, Brenda Goodman, Bradley Jones, Ann Mikolowski, Gordon Newton and The Alternative Press.

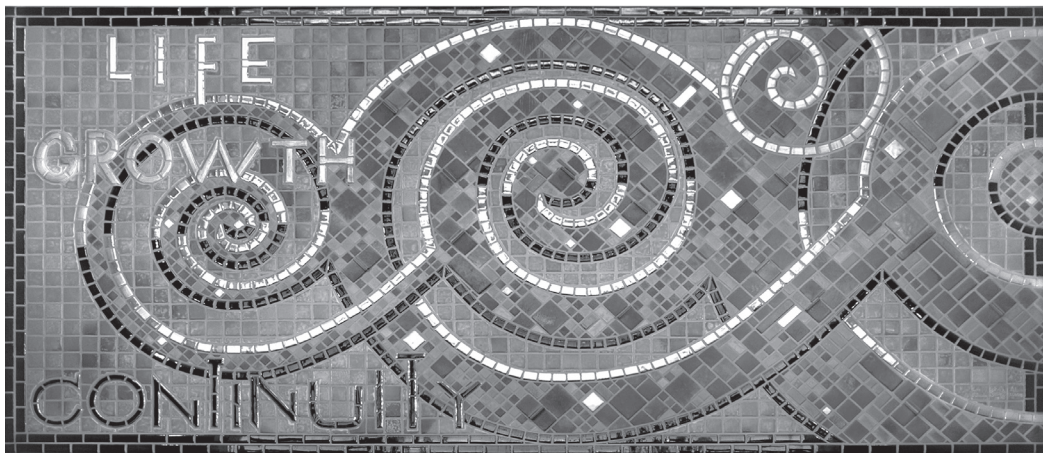

Al Loving, *Life, Growth, Continuity*

A great university always strives to challenge the imagination. Wayne State University believes that a significant way of accomplishing this is by providing provocative and stimulating surroundings for students, faculty, staff and visitors. The Wayne State University Art Collection, which has grown to include nearly 6000 works of art, has proved a primary resource for creating such an environment.

The university's enduring philosophy is that pieces in the WSU Art Collection appear throughout the campus — in signature buildings and on the university's malls and lawns. These works embrace and enhance the everyday lives of people on campus and in the surrounding communities and reinforce Wayne State University's and Detroit's standing as a center for artistic expression.

For further information contact:  
Wayne State University Art Collection  
[www.artcollection.wayne.edu](http://www.artcollection.wayne.edu)  
313 577-9264

Support for *Art at the Adamany* was provided by:



WAYNE STATE UNIVERSITY ART COLLECTION

WAYNE STATE  
UNIVERSITY  
LIBRARY SYSTEM

communityfoundation  
FOR SOUTHEAST MICHIGAN