

ART AT THE ADAMANY

A GUIDE TO WORKS FROM THE UNIVERSITY ART COLLECTION
AT THE DAVID ADAMANY UNDERGRADUATE LIBRARY

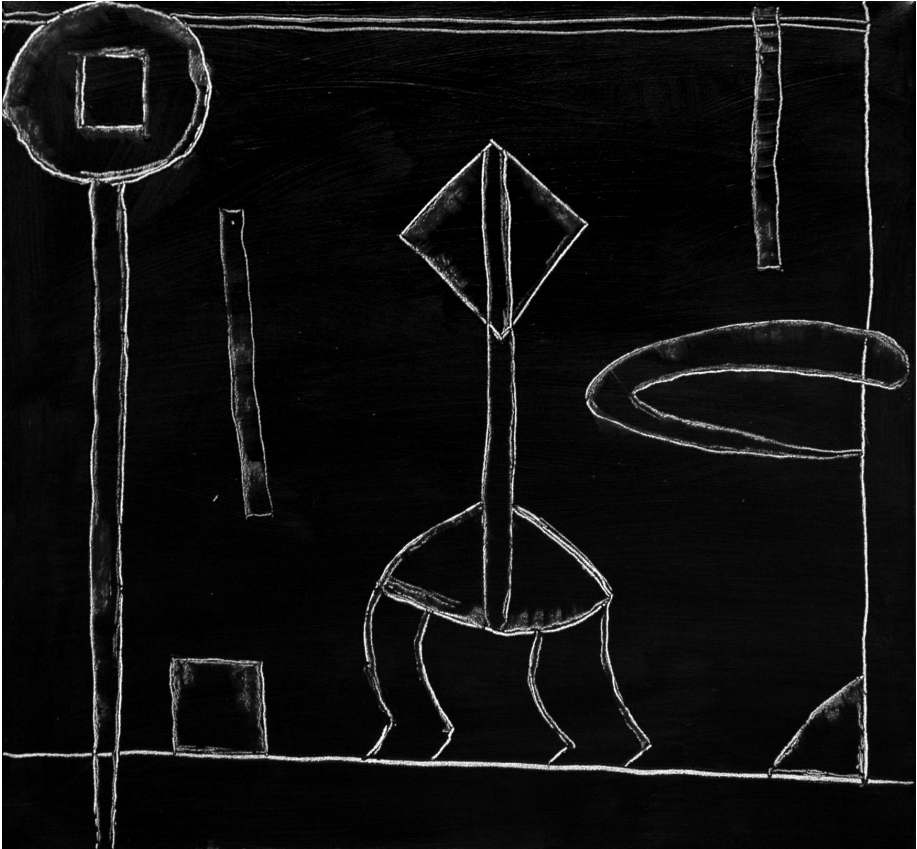



Jonathan Waite, Anxious Moment

The David Adamany Undergraduate Library, as part of the WSU Library System, is committed to providing quality resources, facilities and learning opportunities to students, educators and the community at large.

David W. Adamany, WSU president from 1982-1997, oversaw one of the largest building programs in the university's history and was instrumental in WSU being designated as a 'Research 1' university by the Carnegie Foundation for the Advancement of Teaching. Adamany was also an avid champion of the arts and it is fitting that this building, named in his honor, holds such a wealth of works from the WSU Art Collection. The building's expansive light-filled spaces and generous walls make it a natural for the display of some of the university's most important works.

As you enjoy the art, please be courteous to those around you. When viewing art at the Student Academic Success Services, the Irvin D. Reid Honors College, Community Engagement@Wayne offices and the University Library Dean's offices, please check in with personnel at the front desk and ask for permission to view the art.



John Egner, Untitled (no. 3)

Robert Sestok, Kaleidoscope

FIRST FLOOR

Entrance

Al Loving – Life, Growth, Continuity

This Pewabic tile mosaic, created by Detroit native Al Loving, was dedicated in 1998, one year after the library opened. The energy and message of this mural greet all who enter and sets the tone in creating an environment of art, education and discovery.

Student Academic Success Services

Selections from the WSU Art Collection, featuring many works from Detroit's 'Cass Corridor' artists. (Visit the third floor exhibit Cass Corridor Culture: In and Around Wayne State, 1960's – 1980's to learn more about this important Detroit art movement.)

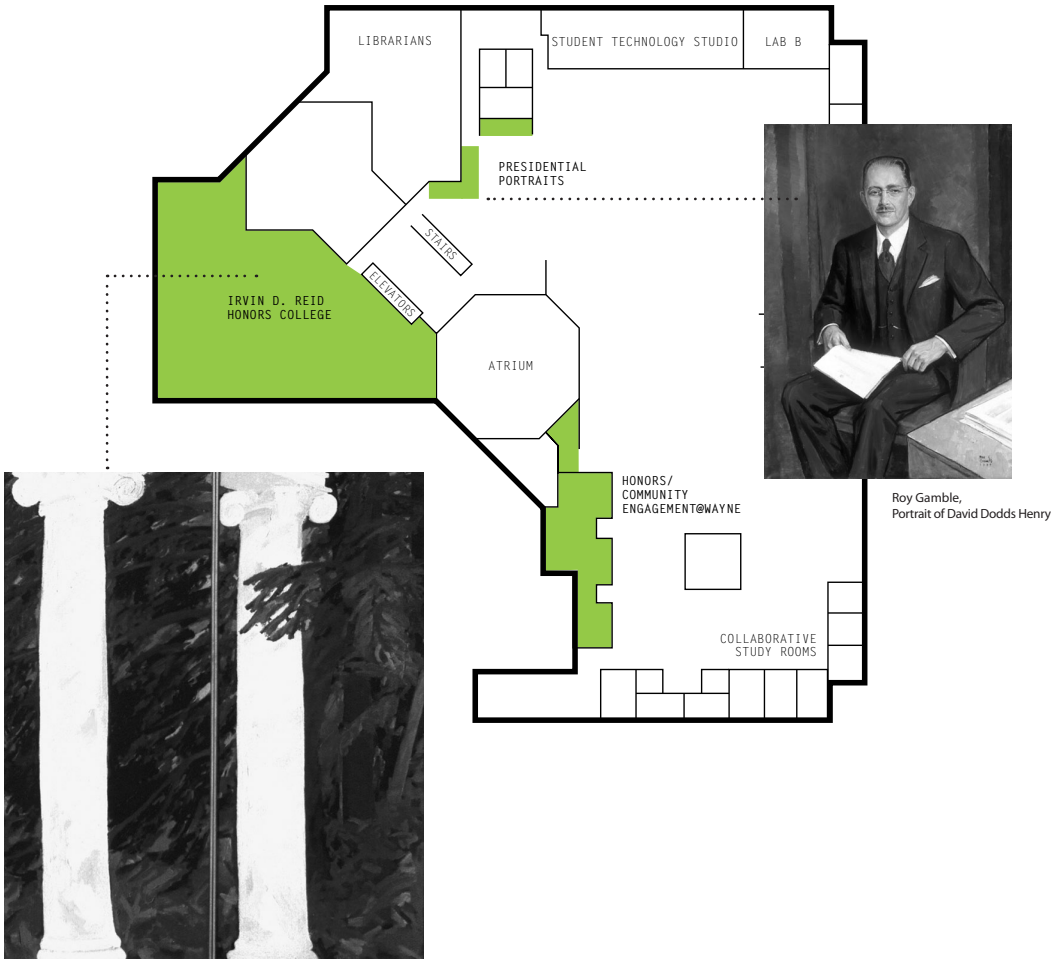

Nancy Mitchnick, Columns and Pine Trees

Roy Gamble, Portrait of David Dodds Henry

SECOND FLOOR

Wayne State University's Presidential Portraits

Exhibited directly across from the elevators and stairs, opposite the Irvin D. Reid Honors College, are portraits of WSU's past Presidents. These portraits trace the academic history of WSU, through the convergence of leadership, culture and tradition. Artists include Lennart Anderson, Roy Gamble, Charles Pompilius and Robert J. Wilbert.

Irvin D. Reid Honors College/Community Engagement@Wayne

Selections from the WSU Art Collection highlighting works by Michael Luchs, Nancy Mitchnick, Robert Sestok and other artists associated with Detroit's Cass Corridor.

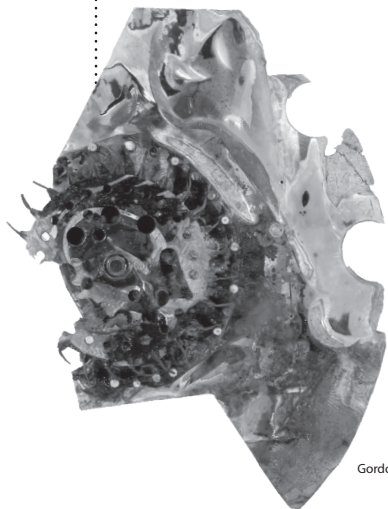
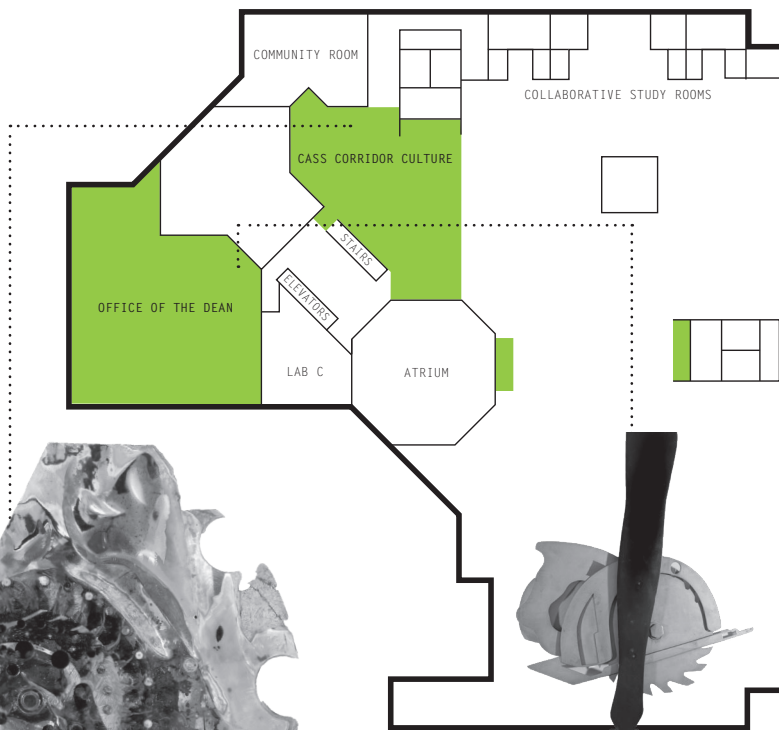

Gordon Newton, Wheel of Fortune

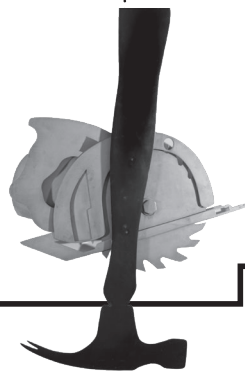

Douglas James, Education of the Schoolboy

THIRD FLOOR

Office of the Dean, University Libraries

Featuring works from the Edward W. Duffy & Company pipe warehouse gifted by James Pearson Duffy to the WSU Art Collection in 1992.

Cass Corridor Culture: In and Around Wayne State, 1960s – 1980s

This permanent exhibition highlights the work of artists, poets and musicians, many of whom lived and worked in 'the Corridor' during those years. The counterculture of the 1960s and '70s had its roots on college and university campuses, including WSU, where artists, musicians, poets and writers developed a strong and vibrant creative community. This display features some of the most iconic art created by artists of the Cass Corridor, including works by Jim Chatelain, John Egner, Brenda Goodman, Bradley Jones, Ann Mikolowski, Gordon Newton and The Alternative Press.

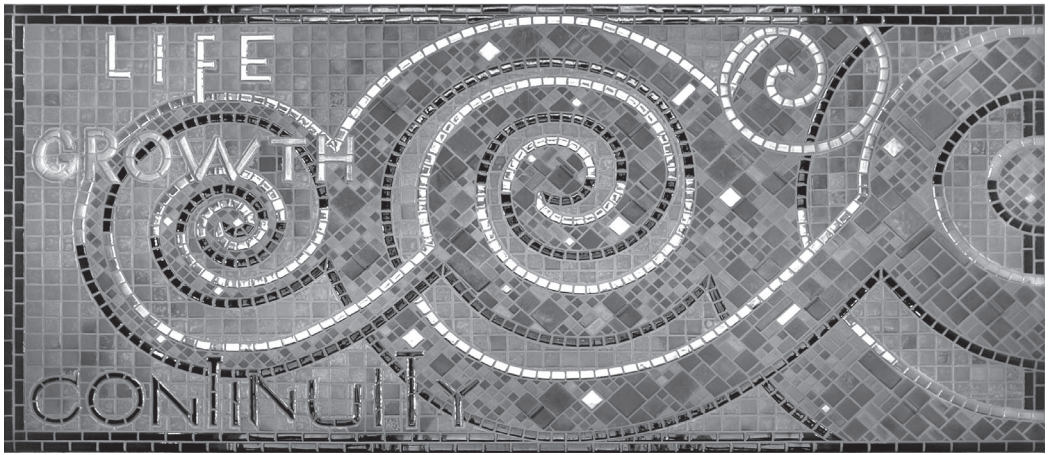

Al Loving, Life, Growth, Continuity

A great university always strives to challenge the imagination. Wayne State University believes that a significant way of accomplishing this is by providing provocative and stimulating surroundings for students, faculty, staff and visitors. The Wayne State University Art Collection, which has grown to include nearly 6000 works of art, has proved a primary resource for creating such an environment.

The university's enduring philosophy is that pieces in the WSU Art Collection appear throughout the campus — in signature buildings and on the university's malls and lawns. These works embrace and enhance the everyday lives of people on campus and in the surrounding communities and reinforce Wayne State University's and Detroit's standing as a center for artistic expression.

For further information contact:
Wayne State University Art Collection
www.artcollection.wayne.edu
313 577-9264

Support for Art at the Adamany was provided by:



WAYNE STATE UNIVERSITY ART COLLECTION

WAYNE STATE
UNIVERSITY
LIBRARY SYSTEM

WAYNE STATE
UNIVERSITY
COLLEGE OF FINE, PERFORMING
AND COMMUNICATION ARTS